

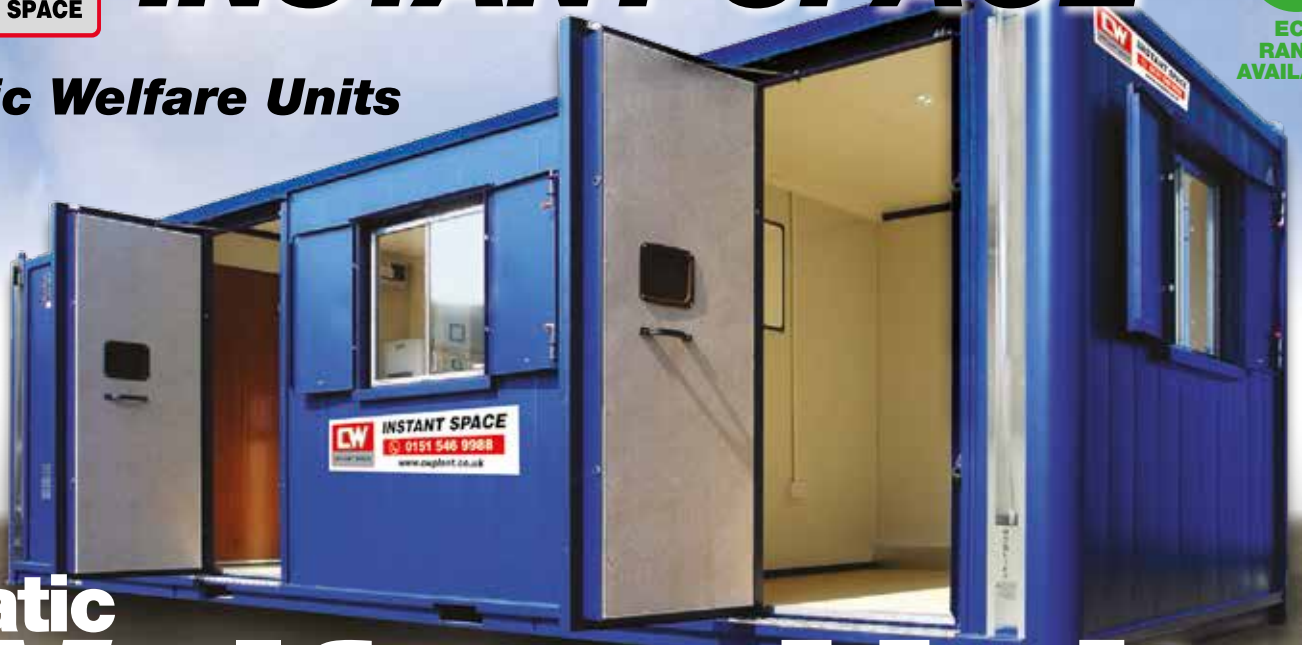

INSTANT SPACE



Static Welfare Units



Static Welfare Units

24ft & 26ft Static Units

The new Static and Mobile Welfare Units from **CW INSTANT SPACE** meet all of the HSE requirements, providing all your on-site needs in one compact, cost-effective package.

HSE Directive

- Flushing toilets should be connected to mains water and drainage where possible. If mains services are not available, facilities with a built in water supply and drainage tank are adequate.
- Portable chemical toilets should be a last resort.
- Hot and Cold running water.
- Area to dry clothes and heat up food.

Static Welfare from Charles Wilson

- ✓ 1000 litres of running water connected to a large waste tank, which is emptied as required.
- ✓ There are no chemical toilets in our Static Welfare Units. All units are water flushable toilets.
- ✓ Hot running water - no electric sink water heaters used.
- ✓ Canteen sits up to 8 people.



Canteen and seating area



Water Tank and Generator



Toilet & wash facilities

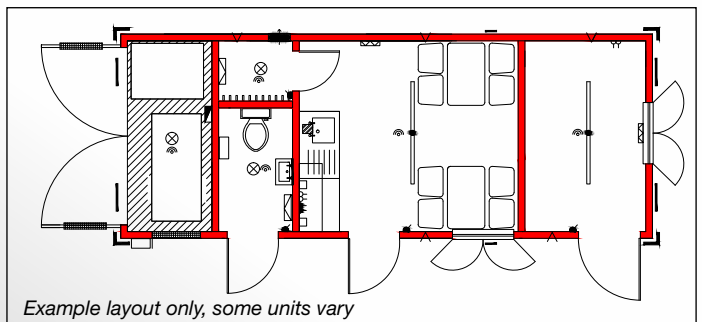

Example layout only, some units vary

www.cwplant.co.uk

cabins@cwplant.co.uk



Welfare Units from

Charles Wilson Engineers Limited



HARPENDEN - Herts/Beds
Tel: 01582 767945

HAYES - W.London/Heathrow
Tel: 020 8573 7717

SIDCUP - S.E. London/Kent
Tel: 020 8303 7711

STRATFORD - E. London
Tel: 020 8555 8100

BOREHAMWOOD - N.W. London
Tel: 020 8207 7050

KENTISH TOWN - N. London
Tel: 020 7267 4320

CRAWLEY - Gatwick/Sussex
Tel: 01293 617766

WANDSWORTH - S.W.London
Tel: 020 8870 2424

BIRMINGHAM - Midlands
Tel: 0121 325 8686

LIVERPOOL - North West
Tel: 0151 546 9988

ASHFORD - South Kent
Tel: 01233 616999

BRISTOL - South West
Tel: 0117 304 1588

BASILDON - Essex
Tel: 01268 722280

SOUTHAMPTON - Hants
Tel: 02380 743777

BARKING - Essex
Tel: 020 8526 8470



INSTANT SPACE



ECO RANGE AVAILABLE

Mobile Welfare Units

The perfect option for fast installation, flexibility and security.



Mobile Welfare Units

12ft x 8ft Mobile Units

The Mobile Welfare unit, from **CW INSTANT SPACE**, is supplied and equipped with an integral generator, toilet area, wash station and drying room. Also included is a canteen area, with cooking facilities, that can seat up to 6 people.

Features include

- All this in a compact unit of just 12' x 8'.
- With its compact size and lightweight design, these units are fitted with a retractable axle and a built in hydraulic system to raise and lower the unit.
- You can be operational on site within minutes of arrival.

Mobile Welfare from Charles Wilson

- ✓ Compact 12ft x 8ft
- ✓ Robust and easy to use
- ✓ Well equipped and seats up to six people
- ✓ Latest 12v technology



Canteen Wash Facilities



Toilet and Power Supply

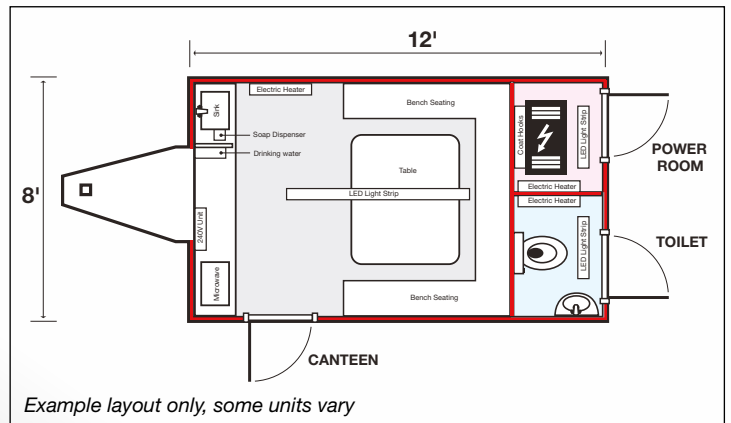

www.cwplant.co.uk

cabins@cwplant.co.uk

NATIONWIDE SERVICE

Welfare Units from

Charles Wilson Engineers Limited



HARPENDEN - Herts/Beds
Tel: 01582 767945

HAYES - W.London/Heathrow
Tel: 020 8573 7717

SIDCUP - S.E. London/Kent
Tel: 020 8303 7711

STRATFORD - E. London
Tel: 020 8555 8100

BOREHAMWOOD - N.W. London
Tel: 020 8207 7050

KENTISH TOWN - N. London
Tel: 020 7267 4320

CRAWLEY - Gatwick/Sussex
Tel: 01293 617766

WANDSWORTH - S.W.London
Tel: 020 8870 2424

BIRMINGHAM - Midlands
Tel: 0121 325 8686

LIVERPOOL - North West
Tel: 0151 546 9988

ASHFORD - South Kent
Tel: 01233 616999

BRISTOL - South West
Tel: 0117 304 1588

BASILDON - Essex
Tel: 01268 722280

SOUTHAMPTON - Hants
Tel: 02380 743777

BARKING - Essex
Tel: 020 8526 8470

Supplied by:

